

TOTAL LEASABLE AREA = 15,020 sq. ft.  
(NOT INCLUDING TENANT PARTITIONS)

FUTURE COMMERCIAL SPACES  
(APPROXIMATE SQUARE FOOTAGE)

- A - 1,960 sq. ft.
- B - 1,530 sq. ft.
- C - 1,530 sq. ft.
- D - 1,220 sq. ft.
- E - 1,105 sq. ft.
- F - 885 sq. ft.
- G - 2,700 sq. ft.
- H - 885 sq. ft.
- I - 1,045 sq. ft.
- J - 925 sq. ft.
- K - 735 sq. ft.
- L - 660 sq. ft.

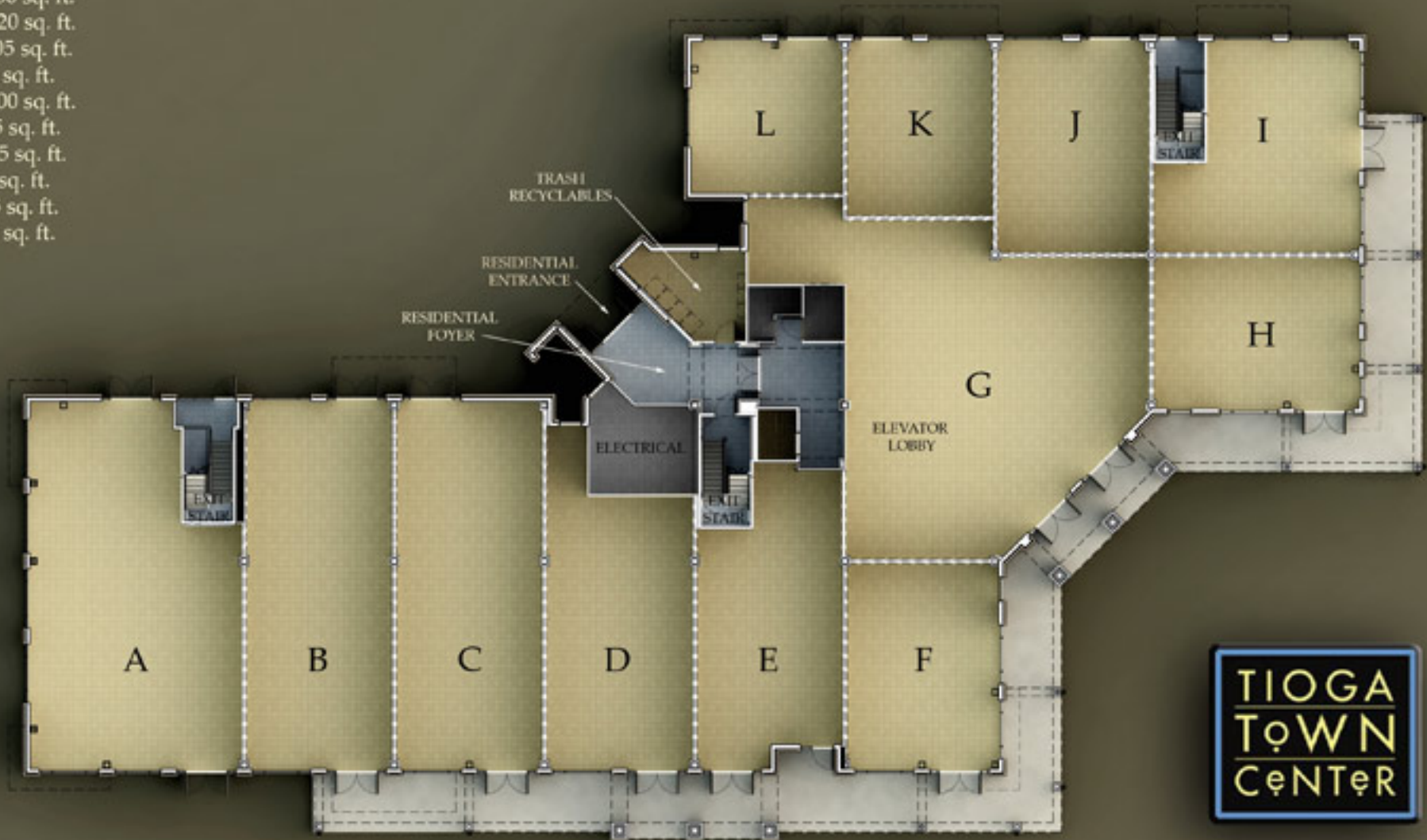

FLOOR PLAN: FIRST FLOOR



*Tioga Town Center, Phase IV - Building No. 8*